

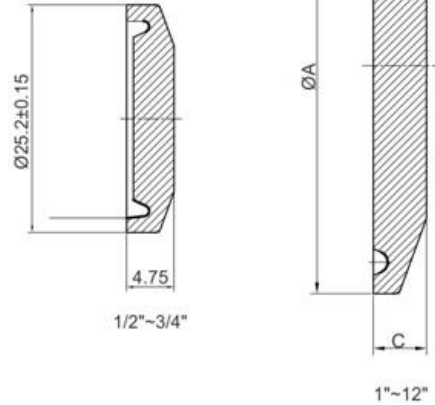

5 Myer Court | Beverley
 South Australia | 5009
 1300 853 250
www.mcc-ltd.com.au
info@mcc-ltd.com.au

Tri-Clover End Cap



SPECIFICATION

Tri-Clover Clamp – End Cap
 Standard: BS4825 / ISO 2852 / DIN 32676 / 3A 63-04
 Pressure Rating: 10 bar
 Working Temperature: 20°C - 150°C

MATERIAL

AISI 304 Austentic Stainless Steel

DIMENSIONAL

NPS (DN)	Part #	A (mm)	C (mm)
25	1TCEC	50.5	6.4
50	2TCEC	64.0	6.4
80	3TCEC	91.0	6.4
100	4TCEC	119.0	7.9

SURFACE FINISH

Ra = 0.4-0.6µm

MARKINGS

XTCEC – X is variable dependant on the size of the liner, refer to “Dimensional” table to see example of part number

